



### COMFORTABLE SEATING

- Wider comfortable seats for 3 (driver + 2 passengers)
- 4-way adjustable driver seat
- Integrated head-rests and arm-rest in centre
- Reduces driver fatigue
- Enhanced overall driving comfort

### WORLD-CLASS CABIN

- All-new world-class steel cabin, aesthetically designed with elegant looks
- 45-degree tiltable cabin – easier engine access, lesser downtime, easier maintenance
- Dash-mounted gear lever – makes it walk through
- Passes pendulum test – reinstates safety
- Company-fitted HVAC
- Utility pockets on the head box – provides more storage space
- Foldable arm rest with storage box and bottle holder, magazine pocket in door trim
- Grab handles for easy ingress/egress
- Hook to hang coat, case for goggles, utilitarian head box

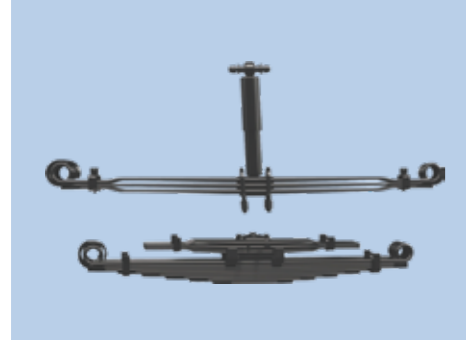

### SUSPENSION

- Front – parabolic leaf for smooth rides and comfort at variable loads
- Rear – semi-elliptical leaf spring
- Tuned shock absorbers – adjustable to GVW
- Front suspension comes with rubber bush

### TYRES

- Radial tubeless tyres with low aspect ratio
- Better torque on wheel
- Longer life compared to tube tyres
- Less rolling resistance – better fuel economy



### LAMPS

- Head lamp – new generation stylised clear lens lamps
- Tail lamp – integrated with LED lamps

TECHNICAL SPECIFICATIONS	Ultra T.14
<b>ENGINE TYPE</b>	5LNGDICR 17
Displacement / Cubic Capacity	5005 cc
Maximum Power Output (in kW)	132 kW (180 ps) @ 2400 r/min
Maximum Torque (in nm)	590 Nm @ 1000-2000 r/min
Bore X Stroke (in mm)	112 mm X 127 mm
Clutch	Single Plate Dry Friction Type-352 mm dia.
Transmission	GBS 750 Synchronesh 6 Forward & 1 Reverse
<b>FUEL SYSTEM</b>	
Fuel Injection System	Common Rail Fuel Injection System
Fuel Tank Capacity (in litres)	160 l
<b>ELECTRICALS</b>	
Battery	24 V, 2x100 Ah
<b>PERFORMANCE</b>	
Gradeability	29.8 %
<b>STEERING</b>	
Steering System	Integral Hydraulic Power-assisted: Tilt and Telescopic
<b>FRAME</b>	
Frame	Ladder-type Frame: 854 mm Width
<b>BRAKES</b>	
Service Brake	Dual Circuit Full Air S-Cam Brake with ABS: Drum-Drum Configuration (Auxiliary Exhaust Brake)
<b>SUSPENSION &amp; TYRES</b>	
Front Suspension	Parabolic Springs
Rear Suspension	Semi-elliptical Leaf Springs with Parabolic Auxiliary Springs
No. of Tyres	Front 2, Rear 4, Spare 1
Front	275/80R 22.5, Tubeless
Rear	275/80R 22.5, Tubeless

<b>WHEELBASE (mm)</b>	5300
FAW (kg)	5700
RAW (kg)	9000
Kerb Weight (kg)	5105
GVM (kg)	14700
<b>OVERALL DIMENSIONS</b>	
Overall Length (mm)	9400
Overall Width (mm)	2440
Overall Height (mm)	2625
Minimum Turning Dia. (m)	15.7
Ground Clearance (mm)	228



For more information, please contact:  
 80 Moo.5 Lam Luk Ka Road, Bueng Kham Phroi, Lam Luk Ka,  
 Pathum Thani 12150 Showroom Lamlukka Tata Motors  
 Website: [www.tatamotors.com](http://www.tatamotors.com), [www.tatamotors.co.th](http://www.tatamotors.co.th)  
 Customer Helpline: [cac@tatamotors.com](mailto:cac@tatamotors.com)

**TATA MOTORS**  
Connecting Aspirations



## GEARED FOR GROWTH, ENGINEERED FOR PROFIT

INTRODUCING THE ALL-NEW ULTRA T.14



Telematics Enabled

Big truck-like power

Small truck-like agility

SUV-like comfort

## NEW GENERATION ENGINE

### 5L New Gen CR Engine

Type	Common Rail Diesel Engine
Number of Cylinders	4 Cylinders; In-line
Bore/Stroke (mm)	112 mm x 127 mm
Capacity (cc)	5005 cc
Max. Engine Output	132 kW (180 ps) @ 2400 r/min
Max. Torque (nm)	590 Nm @ 1000 - 2000 r/min
Emission Compliance	Euro IV



Features	Benefits
<ul style="list-style-type: none"> <li>• SOHC (Single Overhead Camshaft), 4 Valves per Cylinder</li> </ul>	<ul style="list-style-type: none"> <li>• Industry-best flat torque curve - lesser number of gear shifts, fatigueless driving and faster turnaround time, leading to higher number of trips and more revenues</li> <li>• Higher low end torque - superior gradeability and restartability</li> </ul>
<ul style="list-style-type: none"> <li>• Common Rail FIE with Advanced Engine Management System</li> </ul>	<ul style="list-style-type: none"> <li>• Industry-best fuel efficiency</li> <li>• Best-in-class drivability, acceleration, lesser gear shifts and improved gradeability</li> </ul>
<ul style="list-style-type: none"> <li>• Solenoid Injectors</li> </ul>	<ul style="list-style-type: none"> <li>• Solenoid injectors give precise fuel delivery, superior reliability, resulting in increased longevity, durability and efficiency</li> </ul>
<ul style="list-style-type: none"> <li>• DC Motor Linear Electrical EGR with EGR Cooling</li> </ul>	<ul style="list-style-type: none"> <li>• Better fuel economy</li> <li>• Higher engine life due to lesser cylinder temperature</li> <li>• No diesel exhaust fluid (AUS 32 - 32% Aqueous Urea Solution) required</li> <li>• Minimal maintenance</li> </ul>



Rear Axle

Best-in-class Best Durability and Life

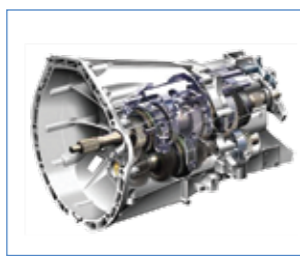

G750

Proven Gearbox with Cast Iron Housing and High Life

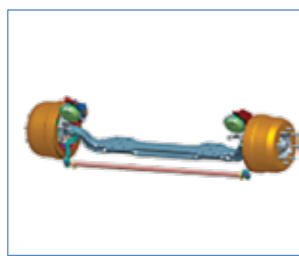

Heavy Duty Front Axle

Durable Front Axle with Higher Life and Best-in-class TCD



Telematics

Vehicle Management System for Fleet Owners

## FEATURE HIGHLIGHTS



World-class cabin comfort



High modularity, strength and durability



Best flat torque curve in its segment



Best-in-class fuel economy in most applications and terrain



Low maintenance and ease of service



Telematics option for fleet operators

Front mirror for foreground visibility & wide angle ORVMs

Panoramic view windshield

Sheet metal 3-piece design bumper

Footstep for windshield cleaning



## MULTIPLE APPLICATIONS



Parcel & Courier



Industrial Components



FMCG



Auto Components



Agri Products



Industrial Pipes



White Goods



Beverages



## INSTRUMENT CLUSTER

- New generation multi-display electronic cluster
- Displays trip and live kmpl indicators – fuel, low air pressure, r/min, speed, brake, seat belt, temperature, economy, time, neutral position, etc.
- Reliable combination switch

## AIR BRAKES

- Safer stopping ability
- Low maintenance
- Higher braking efficiency
- Higher reliability and safety

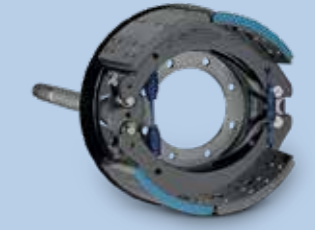

## CONVENIENT FOOTSTEPS

- Easy to enter/exit for both driver & co-driver
- Stylish looks in sync with body design curves & arches

## STEERING

- Power steering with drooping characteristic – stability at high speed
- Tilt & telescopic – suitable for any driver
- Palm effort drivable steering



## SINGLE KEY OPERATION

- For the comfort and ease of driver

## CHASSIS

- Best-in-class strongest chassis with bolted design for increased modularity
- Rolled from HSS 800 (high strength steel with high tensile strength)
- Straight long member – multiple wheelbase options
- Better frame: 7 mm thick, 250 mm deep long members yielding higher durability, excellent torsional bending, and lateral stiffness, best-in-class ride and handling with front anti-roll bar

